

LOT DISCLOSURE PLAN

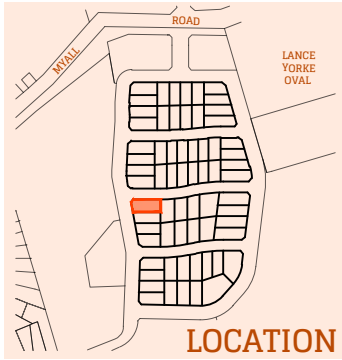

BUSHFIRE ATTACK LEVEL

- APZ
- BAL 29
- BAL 19
- BAL 12.5
- BAL LOW

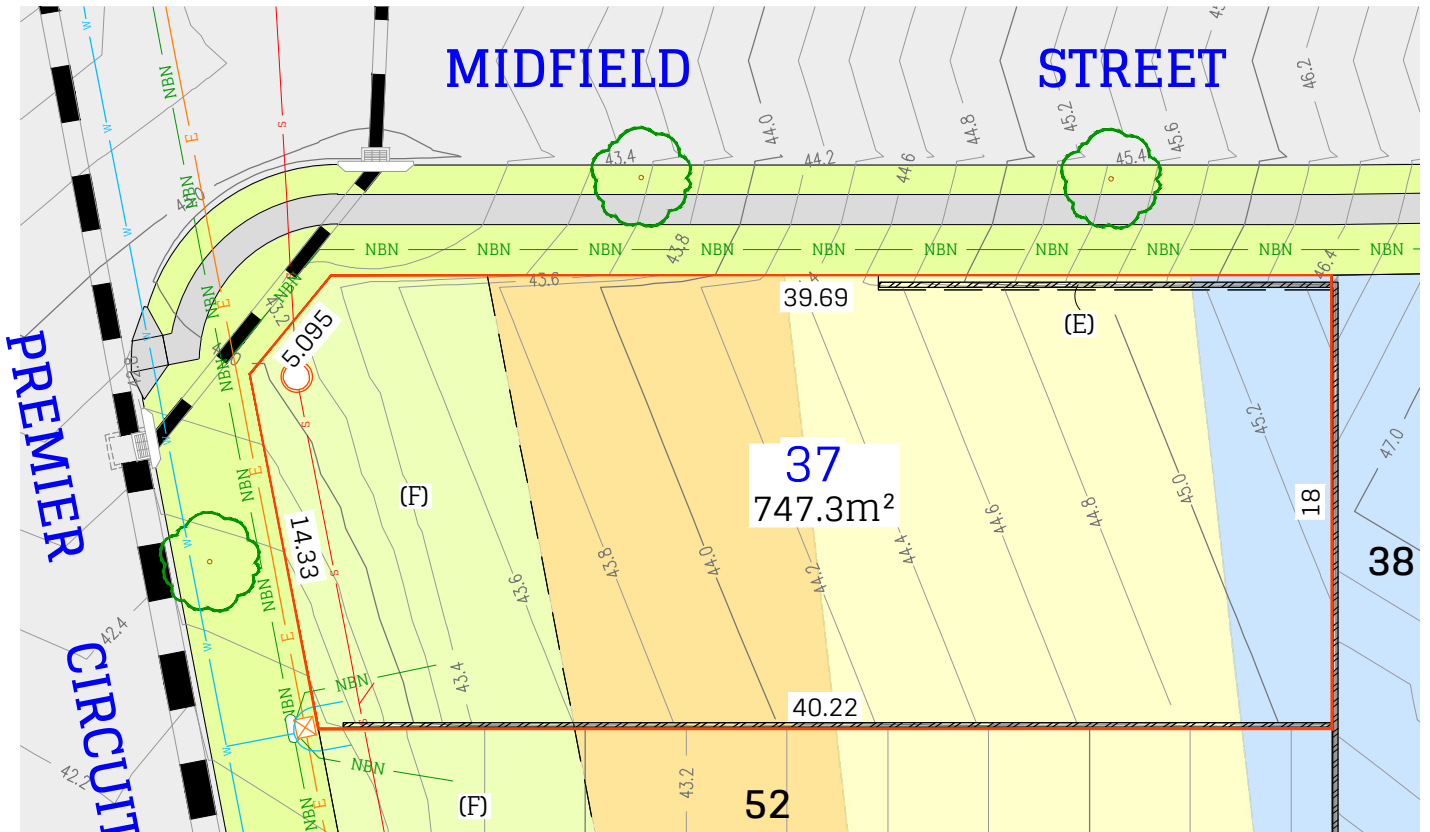

LEGEND:

- Sewer main
- Sewer Man Hole /maintenance shaft
- Water main
- Water Hydrant
- Water Stop Valve
- Stormwater pipe
- Stormwater lintel
- Stormwater Pit
- U/G Electricity services
- Street Light
- Electrical Pillar
- NBN
- NBN Pit
- Retaining Wall
- Design surface contour
- Street Tree

- (E) RESTRICTION ON THE USE OF LAND
- (F) RESTRICTION ON THE USE OF LAND

DISCLAIMER/NOTES:

1. Contours are based on finished design levels and are subject to construction and Council certification and therefore should not be considered as final or as-built.
2. Location of utility services including but not limited to power, water, sewer, communications and are subject to construction and Supply Authority certification and therefore should not be considered as final or as-built.
3. Survey information such as boundary dimensions and areas, easements etc are subject to final survey. Purchasers should refer to the Deposited Plan and 888 Instrument contained in the Contract for Sale of Land for further detailed information.
4. This Preliminary Lot Disclosure Plan has been collated from various sources of design information and is provided for convenience to assist Purchasers in obtaining quotation/tenders for dwelling construction.
5. This document does not form part of the Contract of Sale of the Land.

0 5 10 15

SCALE 1:300 @ A4

REVISION/S: (C)

DATE: 18/03/2026

BY: ADW Johnson 240268 (2)



Sugarwood

LOT DISCLOSURE PLAN

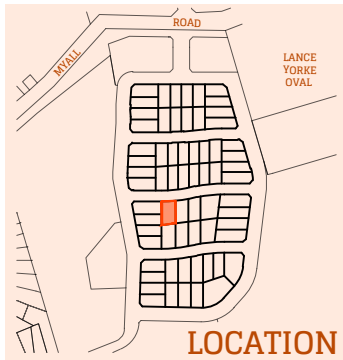

BUSHFIRE ATTACK LEVEL

- APZ
- BAL 29
- BAL 19
- BAL 12.5
- BAL LOW

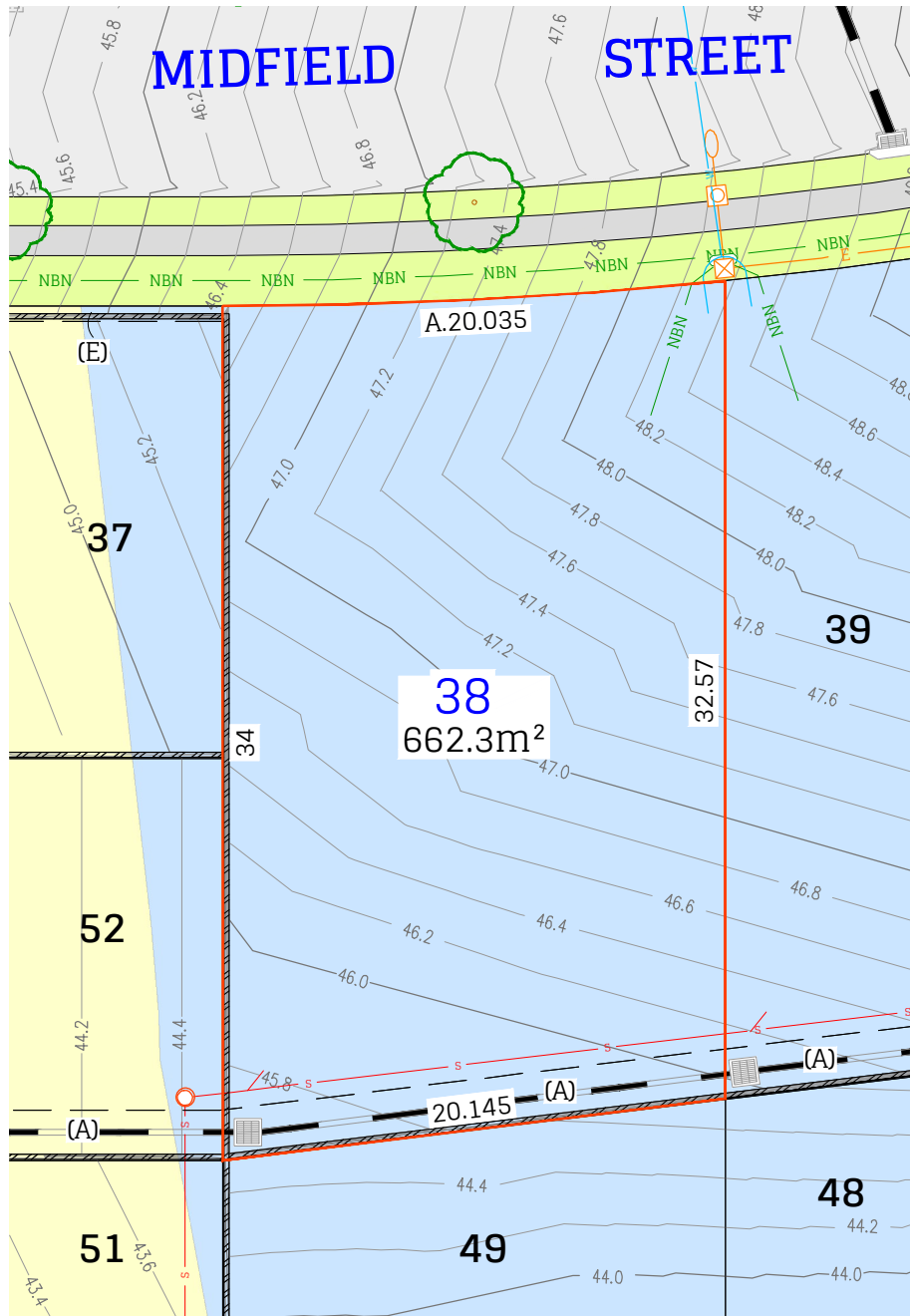

LEGEND:

- Sewer main
- Sewer Man Hole /maintenance shaft
- Water main
- Water Hydrant
- Water Stop Valve
- Stormwater pipe
- Stormwater lintel
- Stormwater Pit
- U/G Electricity services
- Street Light
- Electrical Pillar
- NBN
- NBN Pit
- Retaining Wall
- Design surface contour
- Street Tree

- (A) EASEMENT TO DRAIN WATER 2 WIDE
- (E) RESTRICTION ON THE USE OF LAND

DISCLAIMER/NOTES:

1. Contours are based on finished design levels and are subject to construction and Council certification and therefore should not be considered as final or as-built.
2. Location of utility services including but not limited to power, water, sewer, communications and are subject to construction and Supply Authority certification and therefore should not be considered as final or as-built.
3. Survey information such as boundary dimensions and areas, easements etc are subject to final survey. Purchasers should refer to the Deposited Plan and 888 Instrument contained in the Contract for Sale of Land for further detailed information.
4. This Preliminary Lot Disclosure Plan has been collated from various sources of design information and is provided for convenience to assist Purchasers in obtaining quotation/tenders for dwelling construction.
5. This document does not form part of the Contract of Sale of the Land.

0 5 10 15

SCALE 1:300 @ A4

REVISION/S: (C)

DATE: 18/03/2026

BY: ADW Johnson 240268 (2)



Sugarwood

LOT DISCLOSURE PLAN

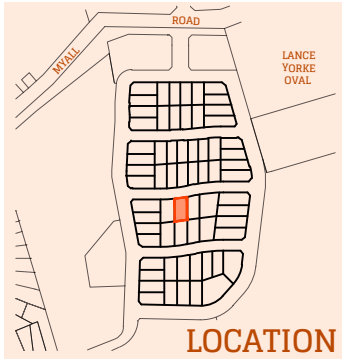

BUSHFIRE ATTACK LEVEL

- APZ
- BAL 29
- BAL 19
- BAL 12.5
- BAL LOW

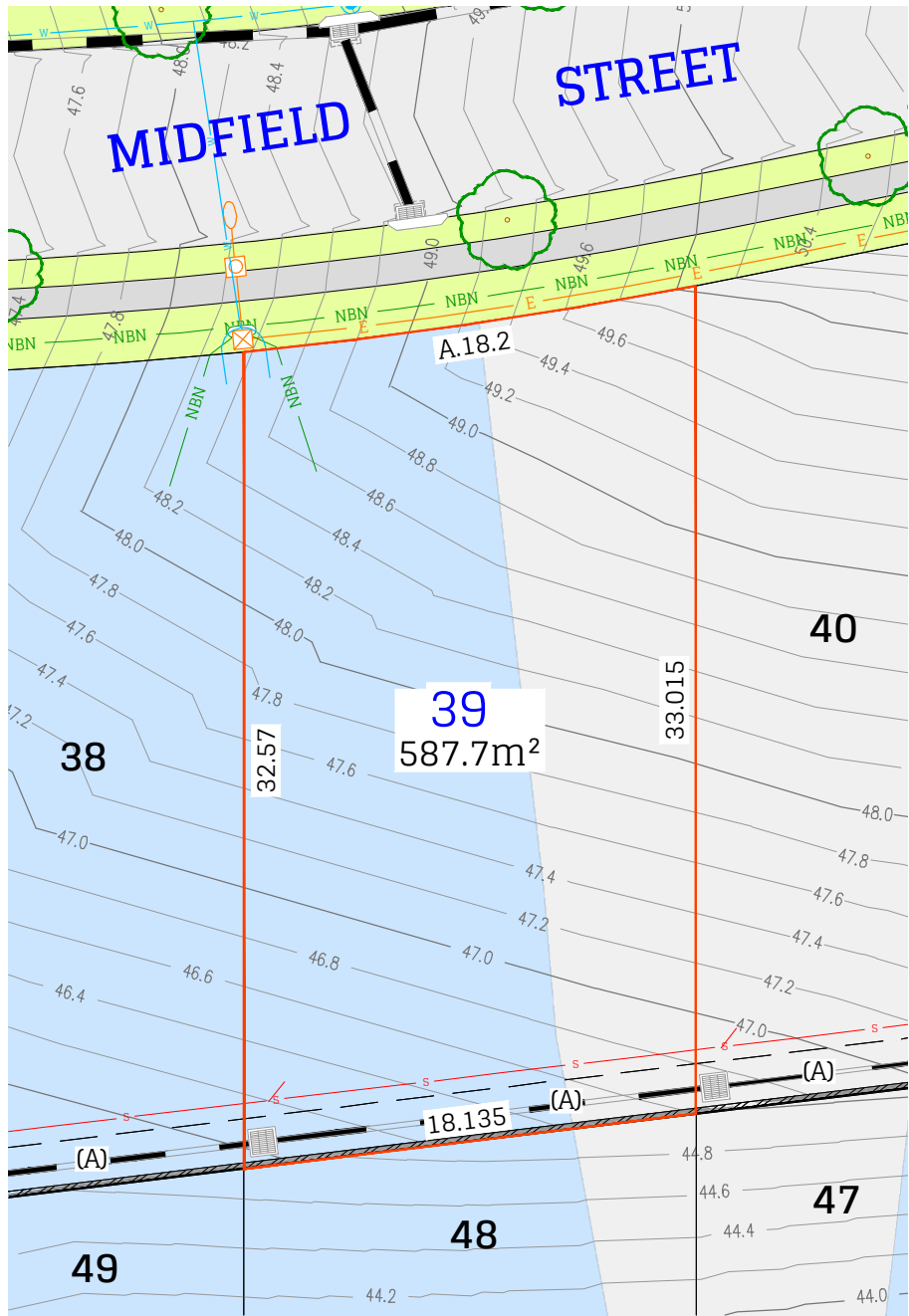

LEGEND:

- Sewer main
- Sewer Man Hole /maintenance shaft
- Water main
- Water Hydrant
- Water Stop Valve
- Stormwater pipe
- Stormwater lintel
- Stormwater Pit
- U/G Electricity services
- Street Light
- Electrical Pillar
- NBN
- NBN Pit
- Retaining Wall
- Design surface contour
- Street Tree

(A) EASEMENT TO DRAIN WATER 2 WIDE

DISCLAIMER/NOTES:

1. Contours are based on finished design levels and are subject to construction and Council certification and therefore should not be considered as final or as-built.
2. Location of utility services including but not limited to power, water, sewer, communications and are subject to construction and Supply Authority certification and therefore should not be considered as final or as-built.
3. Survey information such as boundary dimensions and areas, easements etc are subject to final survey. Purchasers should refer to the Deposited Plan and 888 Instrument contained in the Contract for Sale of Land for further detailed information.
4. This Preliminary Lot Disclosure Plan has been collated from various sources of design information and is provided for convenience to assist Purchasers in obtaining quotation/tenders for dwelling construction.
5. This document does not form part of the Contract of Sale of the Land.



SCALE 1:300 @ A4

REVISION/S: (C)

DATE: 18/03/2026

BY: ADW Johnson 240268 (2)



Sugarwood

LOT DISCLOSURE PLAN

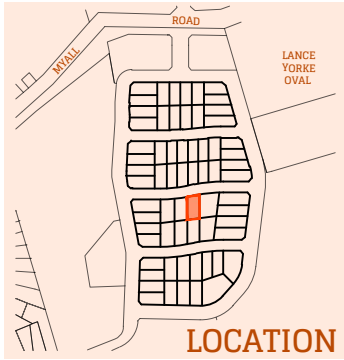

BUSHFIRE ATTACK LEVEL

- APZ
- BAL 29
- BAL 19
- BAL 12.5
- BAL LOW

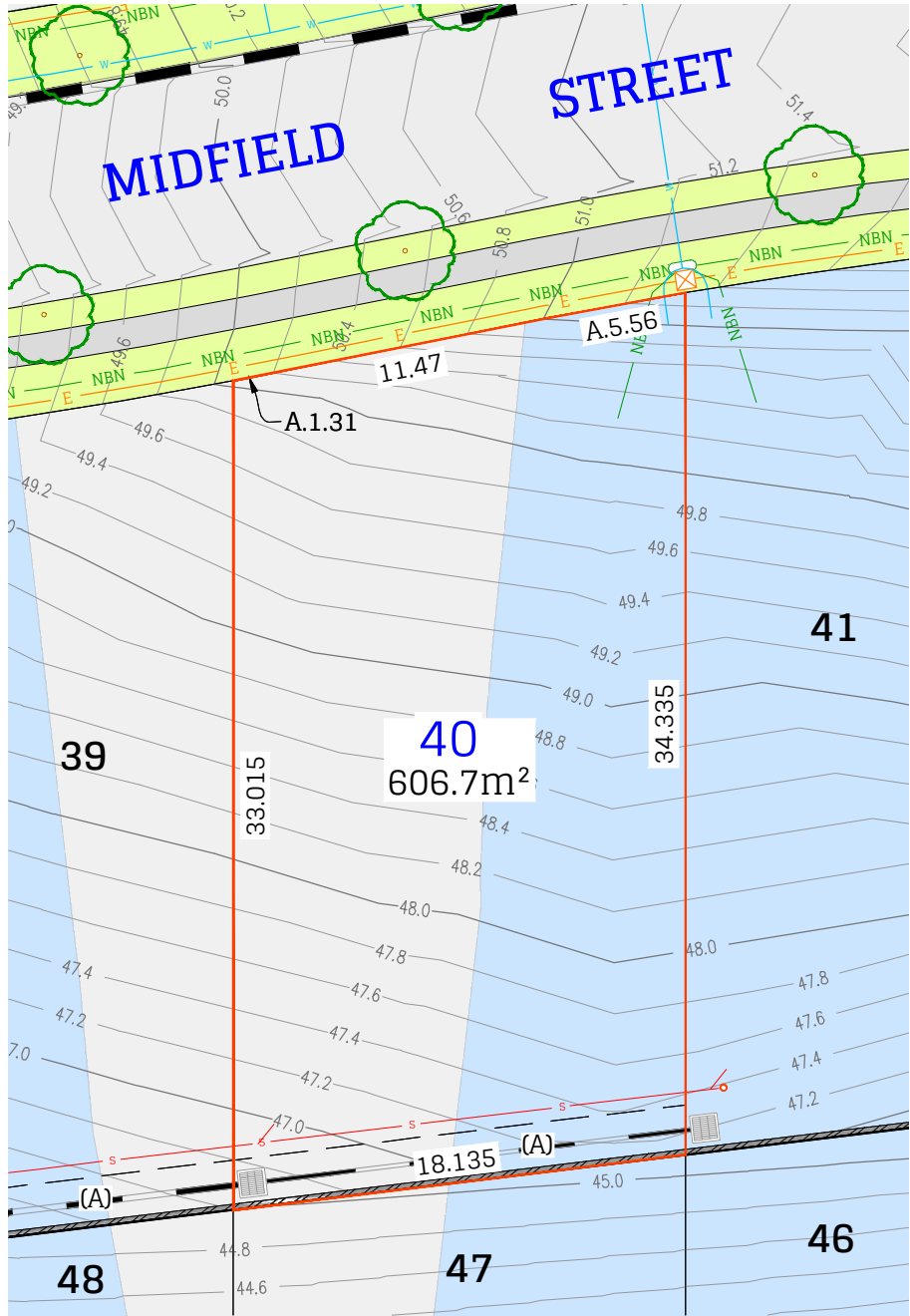

LEGEND:

- Sewer main
- Sewer Man Hole /maintenance shaft
- Water main
- Water Hydrant
- Water Stop Valve
- Stormwater pipe
- Stormwater lintel
- Stormwater Pit
- U/G Electricity services
- Street Light
- Electrical Pillar
- NBN
- NBN Pit
- Retaining Wall
- Design surface contour
- Street Tree

(A) EASEMENT TO DRAIN WATER 2 WIDE

DISCLAIMER/NOTES:

1. Contours are based on finished design levels and are subject to construction and Council certification and therefore should not be considered as final or as-built.
2. Location of utility services including but not limited to power, water, sewer, communications and are subject to construction and Supply Authority certification and therefore should not be considered as final or as-built.
3. Survey information such as boundary dimensions and areas, easements etc are subject to final survey. Purchasers should refer to the Deposited Plan and 888 Instrument contained in the Contract for Sale of Land for further detailed information.
4. This Preliminary Lot Disclosure Plan has been collated from various sources of design information and is provided for convenience to assist Purchasers in obtaining quotation/tenders for dwelling construction.
5. This document does not form part of the Contract of Sale of the Land.

0 5 10 15

SCALE 1:300 @ A4

REVISION/S: (C)

DATE: 18/03/2026

BY: ADW Johnson 240268 (2)



Sugarwood

LOT DISCLOSURE PLAN

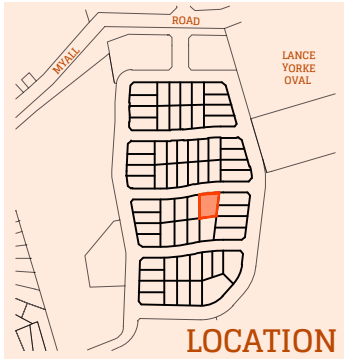

BUSHFIRE ATTACK LEVEL

- APZ
- BAL 29
- BAL 19
- BAL 12.5
- BAL LOW

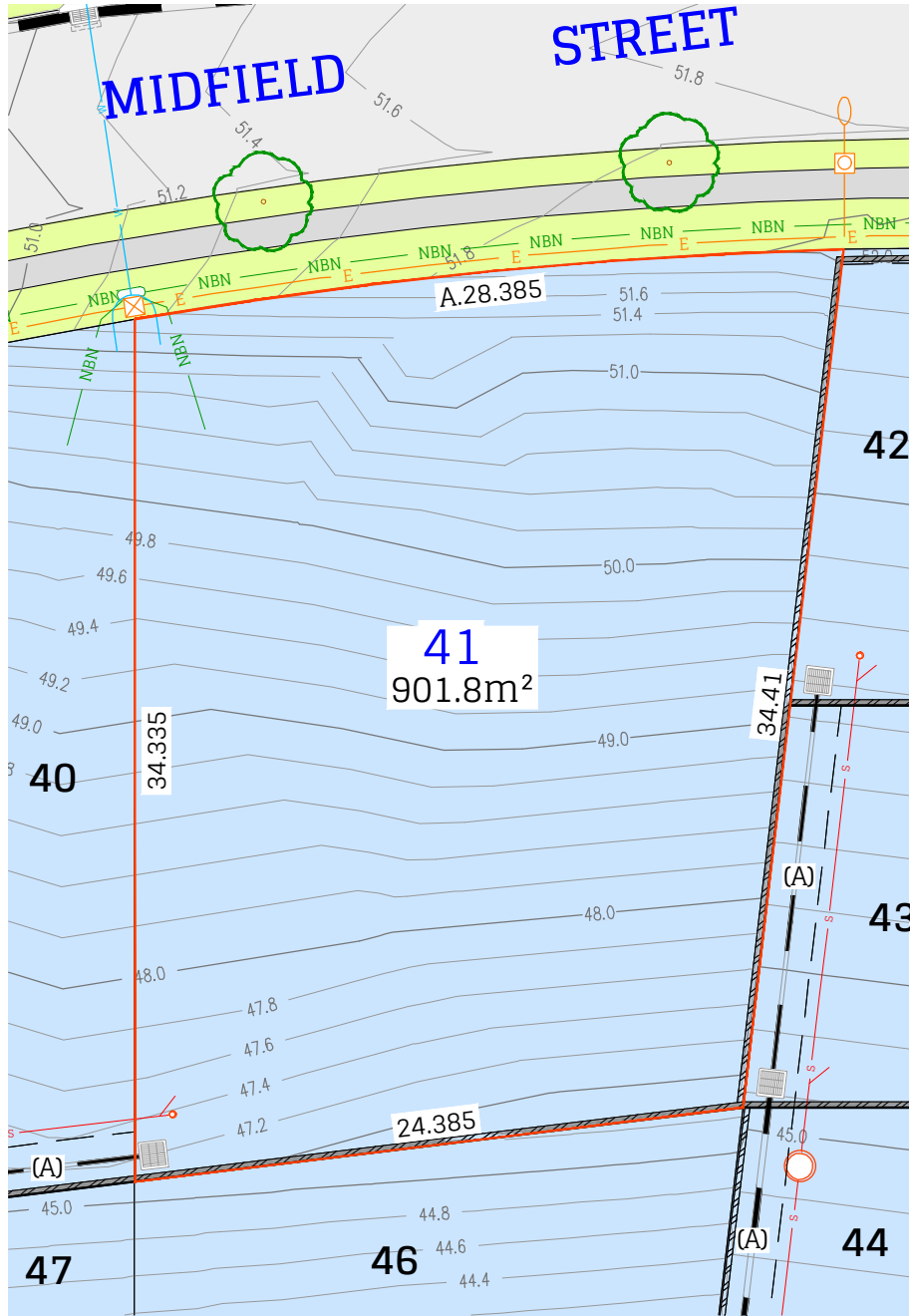

LEGEND:

- Sewer main
- Sewer Man Hole /maintenance shaft
- Water main
- Water Hydrant
- Water Stop Valve
- Stormwater pipe
- Stormwater lintel
- Stormwater Pit
- U/G Electricity services
- Street Light
- Electrical Pillar
- NBN
- NBN Pit
- Retaining Wall
- Design surface contour
- Street Tree

(A) EASEMENT TO DRAIN WATER 2 WIDE

DISCLAIMER/NOTES:

1. Contours are based on finished design levels and are subject to construction and Council certification and therefore should not be considered as final or as-built.
2. Location of utility services including but not limited to power, water, sewer, communications and are subject to construction and Supply Authority certification and therefore should not be considered as final or as-built.
3. Survey information such as boundary dimensions and areas, easements etc are subject to final survey. Purchasers should refer to the Deposited Plan and 888 Instrument contained in the Contract for Sale of Land for further detailed information.
4. This Preliminary Lot Disclosure Plan has been collated from various sources of design information and is provided for convenience to assist Purchasers in obtaining quotation/tenders for dwelling construction.
5. This document does not form part of the Contract of Sale of the Land.

0 5 10 15

SCALE 1:300 @ A4

REVISION/S: (C)

DATE: 18/03/2026

BY: ADW Johnson 240268 (2)



Sugarwood

LOT DISCLOSURE PLAN

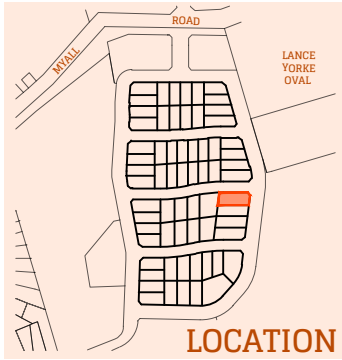

BUSHFIRE ATTACK LEVEL

- APZ
- BAL 29
- BAL 19
- BAL 12.5
- BAL LOW

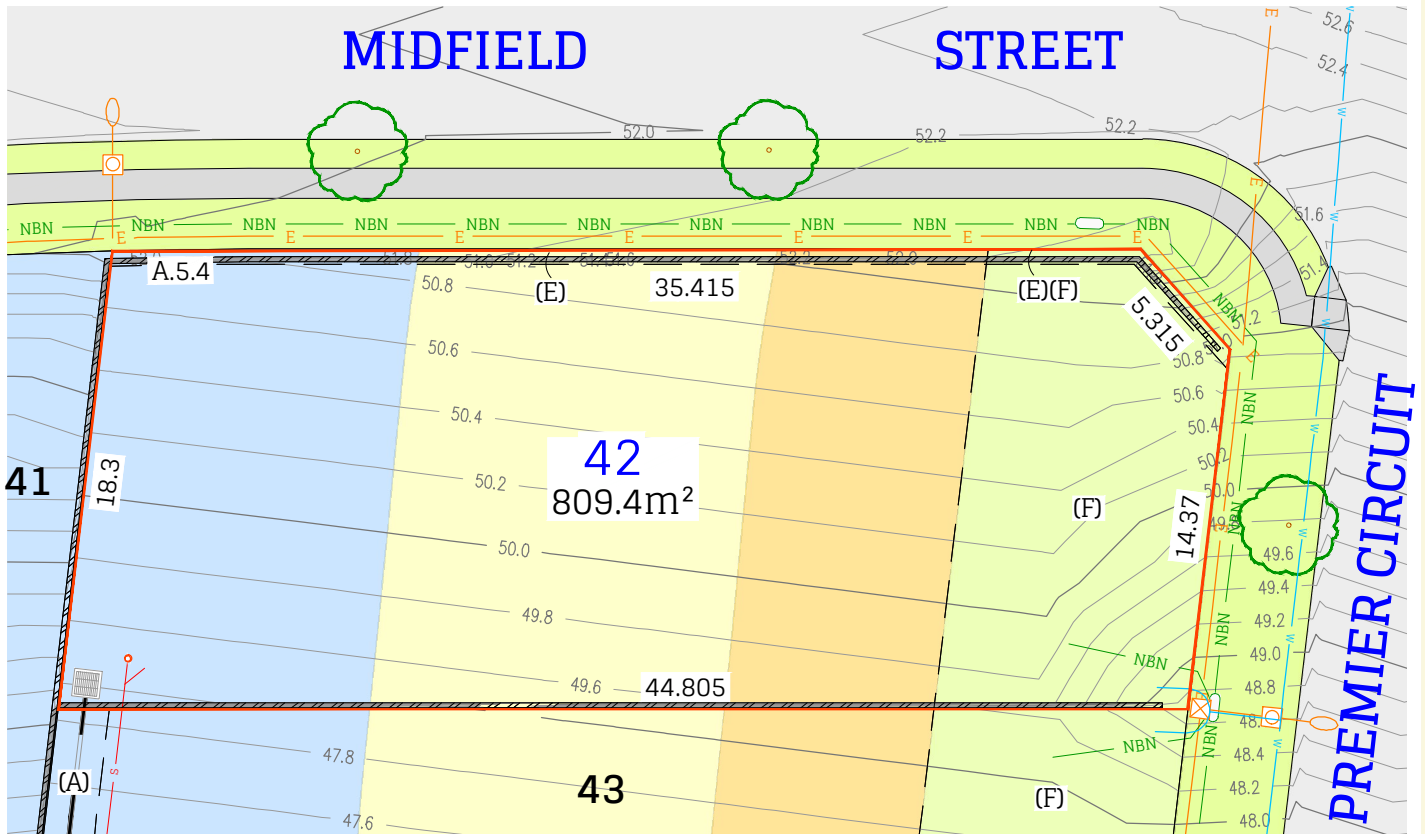

LEGEND:

- Sewer main
- Sewer Man Hole /maintenance shaft
- Water main
- Water Hydrant
- Water Stop Valve
- Stormwater pipe
- Stormwater lintel
- Stormwater Pit
- U/G Electricity services
- Street Light
- Electrical Pillar
- NBN
- NBN Pit
- Retaining Wall
- Design surface contour
- Street Tree

- (A) EASEMENT TO DRAIN WATER 2 WIDE
- (E) RESTRICTION ON THE USE OF LAND
- (F) RESTRICTION ON THE USE OF LAND

DISCLAIMER/NOTES:

1. Contours are based on finished design levels and are subject to construction and Council certification and therefore should not be considered as final or as-built.
2. Location of utility services including but not limited to power, water, sewer, communications and are subject to construction and Supply Authority certification and therefore should not be considered as final or as-built.
3. Survey information such as boundary dimensions and areas, easements etc are subject to final survey. Purchasers should refer to the Deposited Plan and 888 Instrument contained in the Contract for Sale of Land for further detailed information.
4. This Preliminary Lot Disclosure Plan has been collated from various sources of design information and is provided for convenience to assist Purchasers in obtaining quotation/tenders for dwelling construction.
5. This document does not form part of the Contract of Sale of the Land.



SCALE 1:300 @ A4

REVISION/S: (C)
 DATE: 18/03/2026
 BY: ADW Johnson 240268 (2)



Sugarwood

LOT DISCLOSURE PLAN

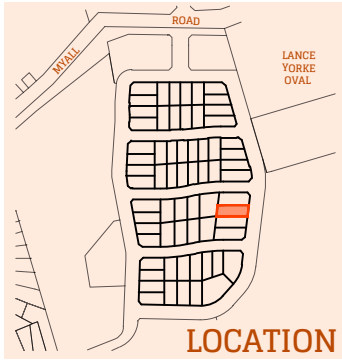

BUSHFIRE ATTACK LEVEL

APZ
BAL 29
BAL 19
BAL 12.5
BAL LOW

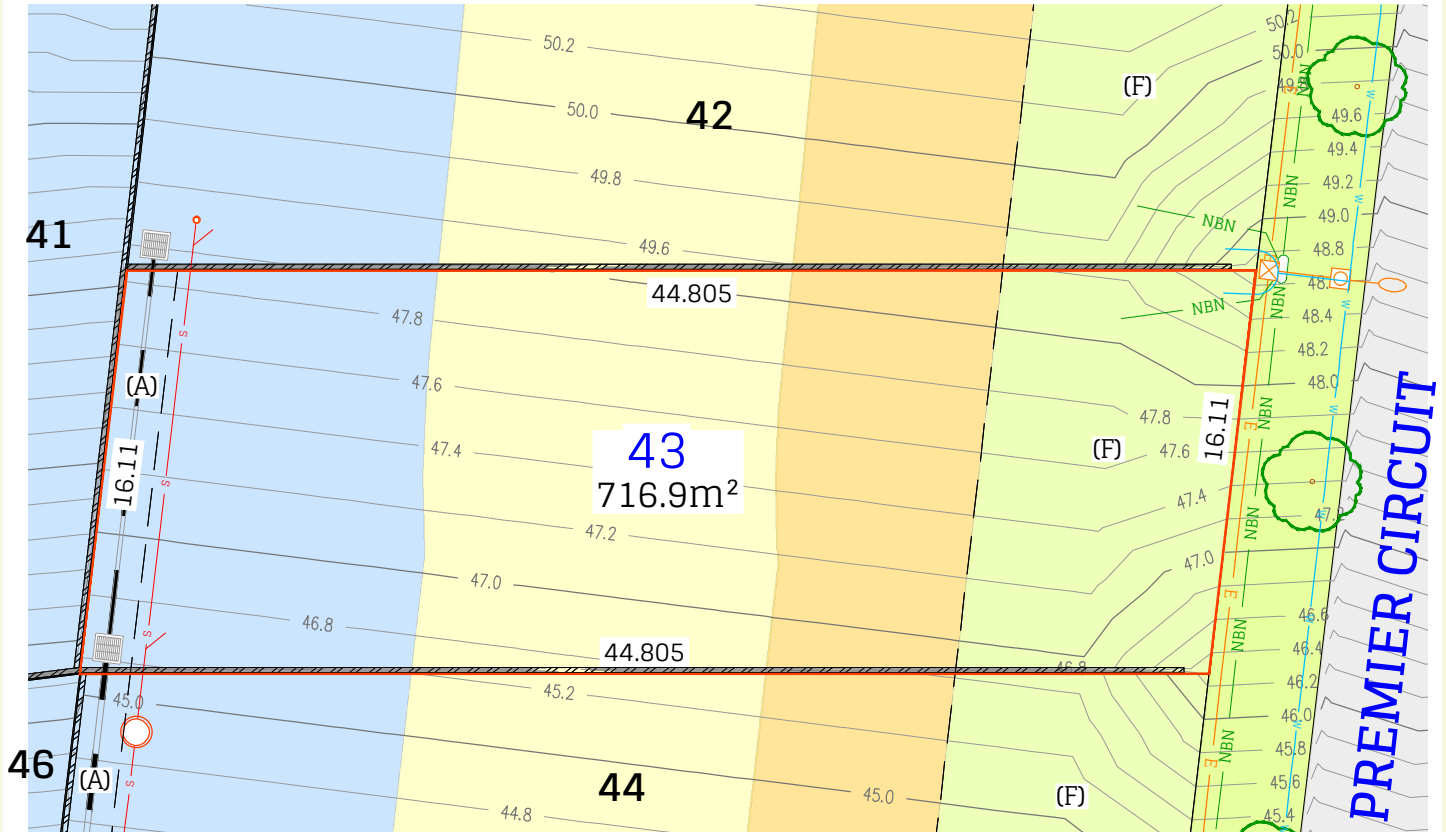

LEGEND:

- Sewer main
- Sewer Man Hole /maintenance shaft
- Water main
- Water Hydrant
- Water Stop Valve
- Stormwater pipe
- Stormwater lintel
- Stormwater Pit
- U/G Electricity services
- Street Light
- Electrical Pillar
- NBN
- NBN Pit
- Retaining Wall
- Design surface contour
- Street Tree

- (A) EASEMENT TO DRAIN WATER 2 WIDE
- (F) RESTRICTION ON THE USE OF LAND

DISCLAIMER/NOTES:

- Contours are based on finished design levels and are subject to construction and Council certification and therefore should not be considered as final or as-built.
- Location of utility services including but not limited to power, water, sewer, communications and are subject to construction and Supply Authority certification and therefore should not be considered as final or as-built.
- Survey information such as boundary dimensions and areas, easements etc are subject to final survey. Purchasers should refer to the Deposited Plan and 88b Instrument contained in the Contract for Sale of Land for further detailed information.
- This Preliminary Lot Disclosure Plan has been collated from various sources of design information and is provided for convenience to assist Purchasers in obtaining quotation/tenders for dwelling construction.
- This document does not form part of the Contract of Sale of the Land.



SCALE 1:300 @ A4

REVISION/S: (C)
 DATE: 18/03/2026
 BY: ADW Johnson 240268 (2)



Sugarwood

LOT DISCLOSURE PLAN

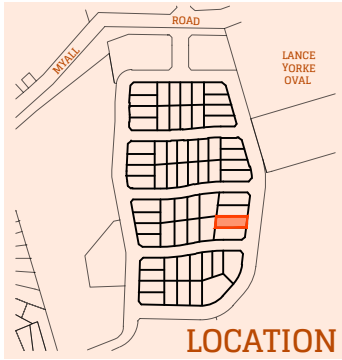

BUSHFIRE ATTACK LEVEL

- APZ
- BAL 29
- BAL 19
- BAL 12.5
- BAL LOW

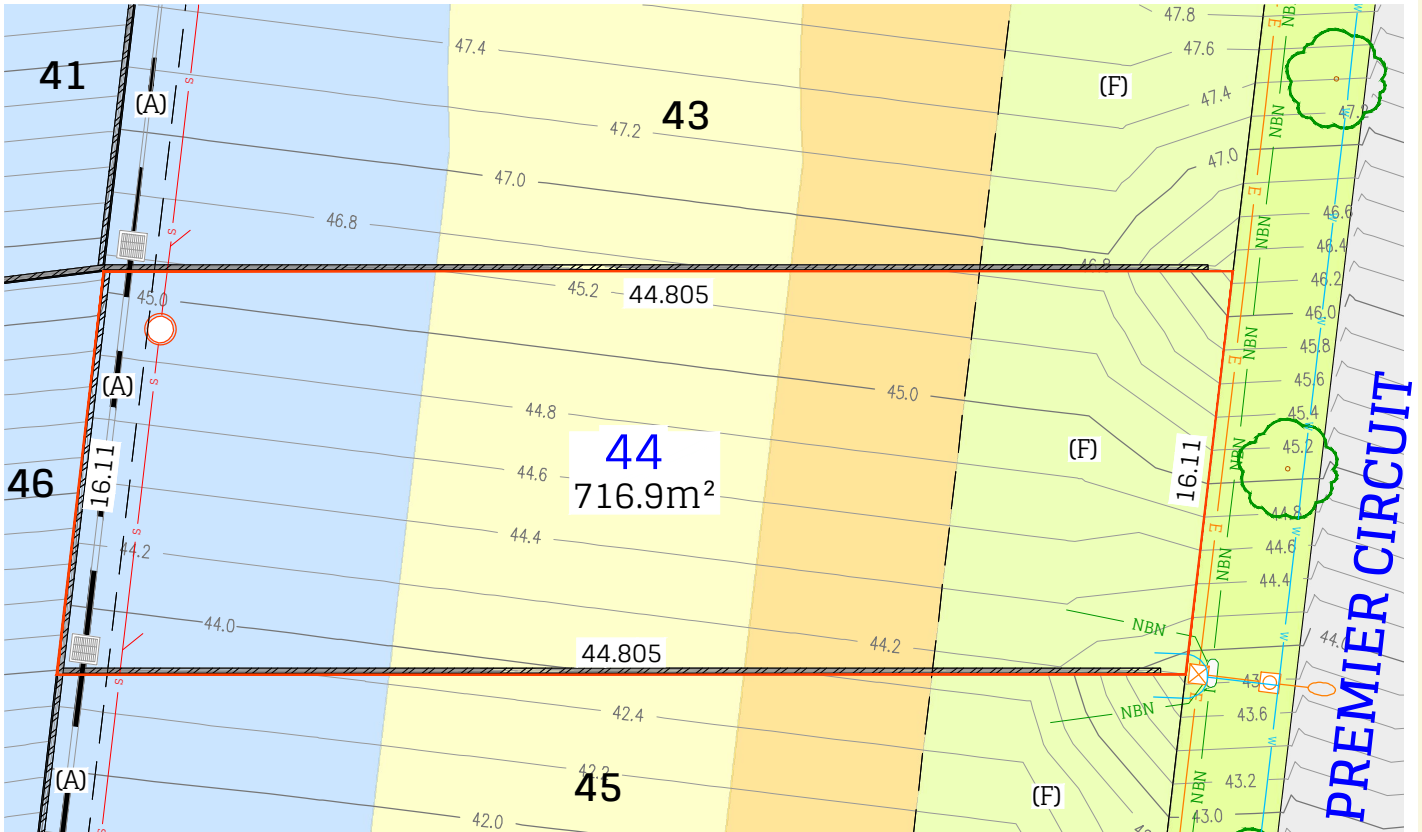

LEGEND:

- Sewer main
- Sewer Man Hole /maintenance shaft
- Water main
- Water Hydrant
- Water Stop Valve
- Stormwater pipe
- Stormwater lintel
- Stormwater Pit
- U/G Electricity services
- Street Light
- Electrical Pillar
- NBN
- NBN Pit
- Retaining Wall
- Design surface contour
- Street Tree

- (A) EASEMENT TO DRAIN WATER 2 WIDE
- (F) RESTRICTION ON THE USE OF LAND

DISCLAIMER/NOTES:

1. Contours are based on finished design levels and are subject to construction and Council certification and therefore should not be considered as final or as-built.
2. Location of utility services including but not limited to power, water, sewer, communications and are subject to construction and Supply Authority certification and therefore should not be considered as final or as-built.
3. Survey information such as boundary dimensions and areas, easements etc are subject to final survey. Purchasers should refer to the Deposited Plan and 888 Instrument contained in the Contract for Sale of Land for further detailed information.
4. This Preliminary Lot Disclosure Plan has been collated from various sources of design information and is provided for convenience to assist Purchasers in obtaining quotation/tenders for dwelling construction.
5. This document does not form part of the Contract of Sale of the Land.



SCALE 1:300 @ A4

REVISION/S: (C)

DATE: 18/03/2026

BY: ADW Johnson 240268 (2)



Sugarwood

LOT DISCLOSURE PLAN

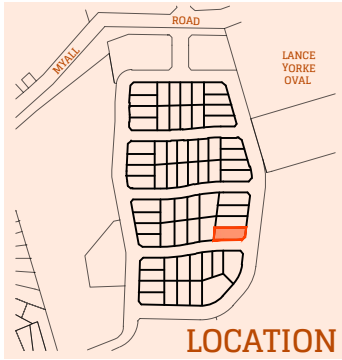

BUSHFIRE ATTACK LEVEL

- APZ
- BAL 29
- BAL 19
- BAL 12.5
- BAL LOW

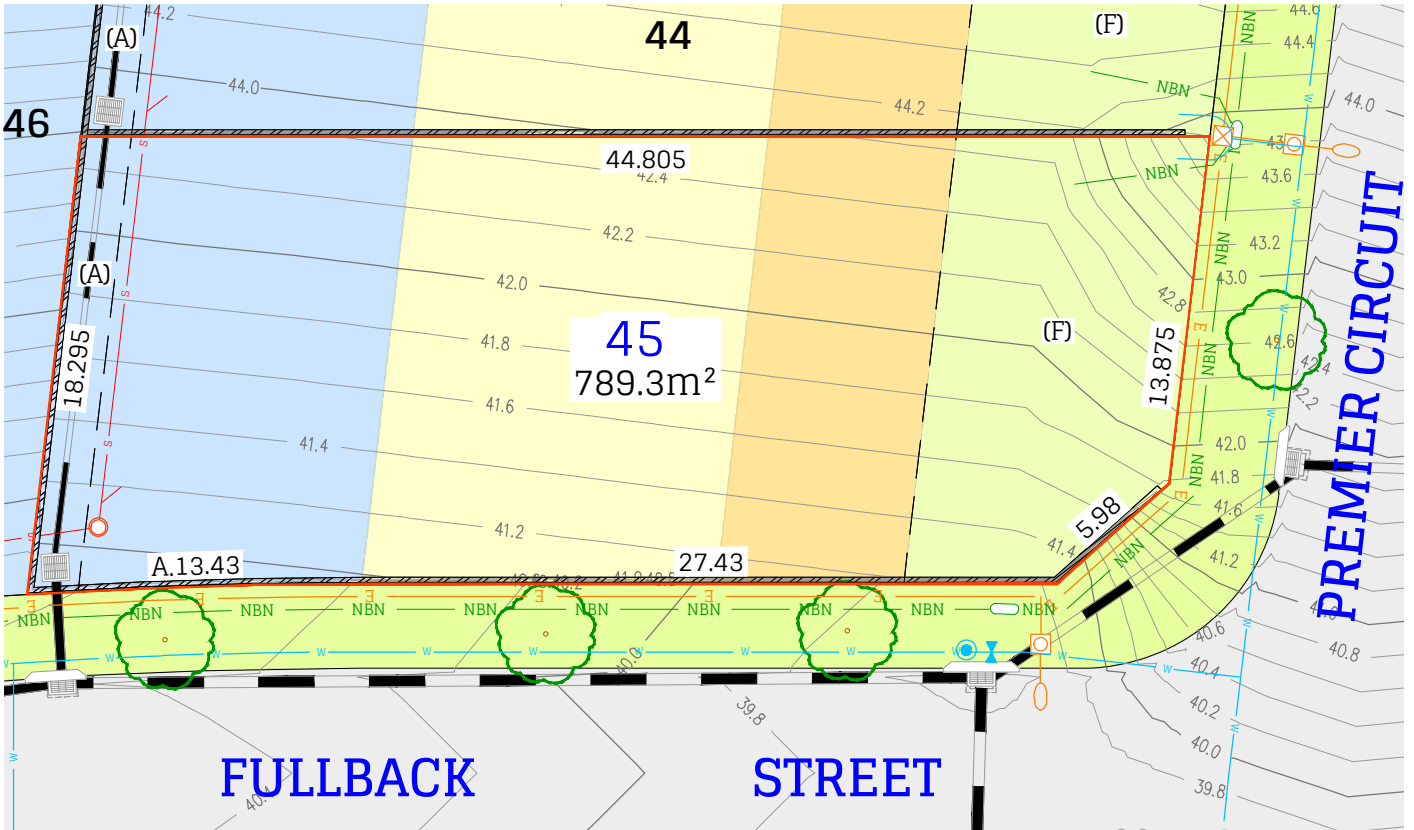

LEGEND:

- Sewer main
- Sewer Man Hole /maintenance shaft
- Water main
- Water Hydrant
- Water Stop Valve
- Stormwater pipe
- Stormwater lintel
- Stormwater Pit
- U/G Electricity services
- Street Light
- Electrical Pillar
- NBN
- NBN Pit
- Retaining Wall
- Design surface contour
- Street Tree

- (A) EASEMENT TO DRAIN WATER 2 WIDE
- (F) RESTRICTION ON THE USE OF LAND

DISCLAIMER/NOTES:

1. Contours are based on finished design levels and are subject to construction and Council certification and therefore should not be considered as final or as-built.
2. Location of utility services including but not limited to power, water, sewer, communications and are subject to construction and Supply Authority certification and therefore should not be considered as final or as-built.
3. Survey information such as boundary dimensions and areas, easements etc are subject to final survey. Purchasers should refer to the Deposited Plan and 888 Instrument contained in the Contract for Sale of Land for further detailed information.
4. This Preliminary Lot Disclosure Plan has been collated from various sources of design information and is provided for convenience to assist Purchasers in obtaining quotation/tenders for dwelling construction.
5. This document does not form part of the Contract of Sale of the Land.

0 5 10 15

SCALE 1:300 @ A4

REVISION/S: (C)

DATE: 18/03/2026

BY: ADW Johnson 240268 (2)



Sugarwood

LOT DISCLOSURE PLAN



BUSHFIRE ATTACK LEVEL

- APZ
- BAL 29
- BAL 19
- BAL 12.5
- BAL LOW

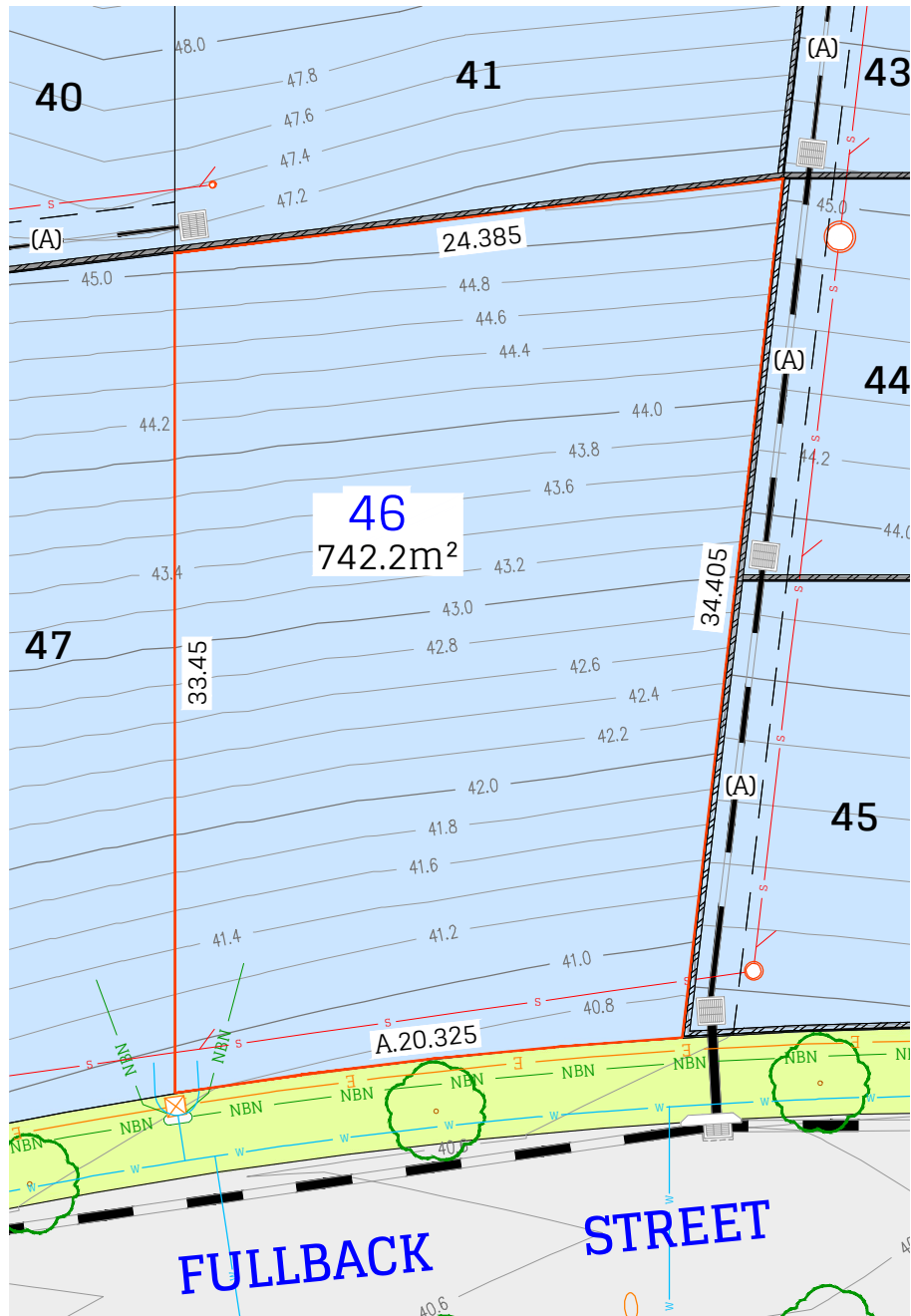

LEGEND:

- Sewer main
- Sewer Man Hole /maintenance shaft
- Water main
- Water Hydrant
- Water Stop Valve
- Stormwater pipe
- Stormwater lintel
- Stormwater Pit
- U/G Electricity services
- Street Light
- Electrical Pillar
- NBN
- NBN Pit
- Retaining Wall
- Design surface contour
- Street Tree

(A) EASEMENT TO DRAIN WATER 2 WIDE

DISCLAIMER/NOTES:

1. Contours are based on finished design levels and are subject to construction and Council certification and therefore should not be considered as final or as-built.
2. Location of utility services including but not limited to power, water, sewer, communications and are subject to construction and Supply Authority certification and therefore should not be considered as final or as-built.
3. Survey information such as boundary dimensions and areas, easements etc are subject to final survey. Purchasers should refer to the Deposited Plan and 888 Instrument contained in the Contract for Sale of Land for further detailed information.
4. This Preliminary Lot Disclosure Plan has been collated from various sources of design information and is provided for convenience to assist Purchasers in obtaining quotation/tenders for dwelling construction.
5. This document does not form part of the Contract of Sale of the Land.

0 5 10 15

SCALE 1:300 @ A4

REVISION/S: (C)

DATE: 18/03/2026

BY: ADW Johnson 240268 (2)



Sugarwood

LOT DISCLOSURE PLAN

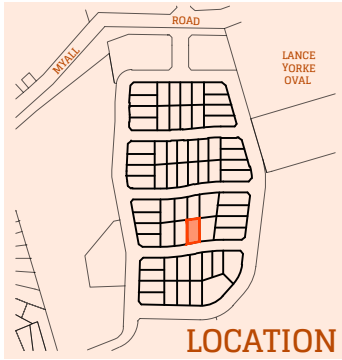

BUSHFIRE ATTACK LEVEL

- APZ
- BAL 29
- BAL 19
- BAL 12.5
- BAL LOW

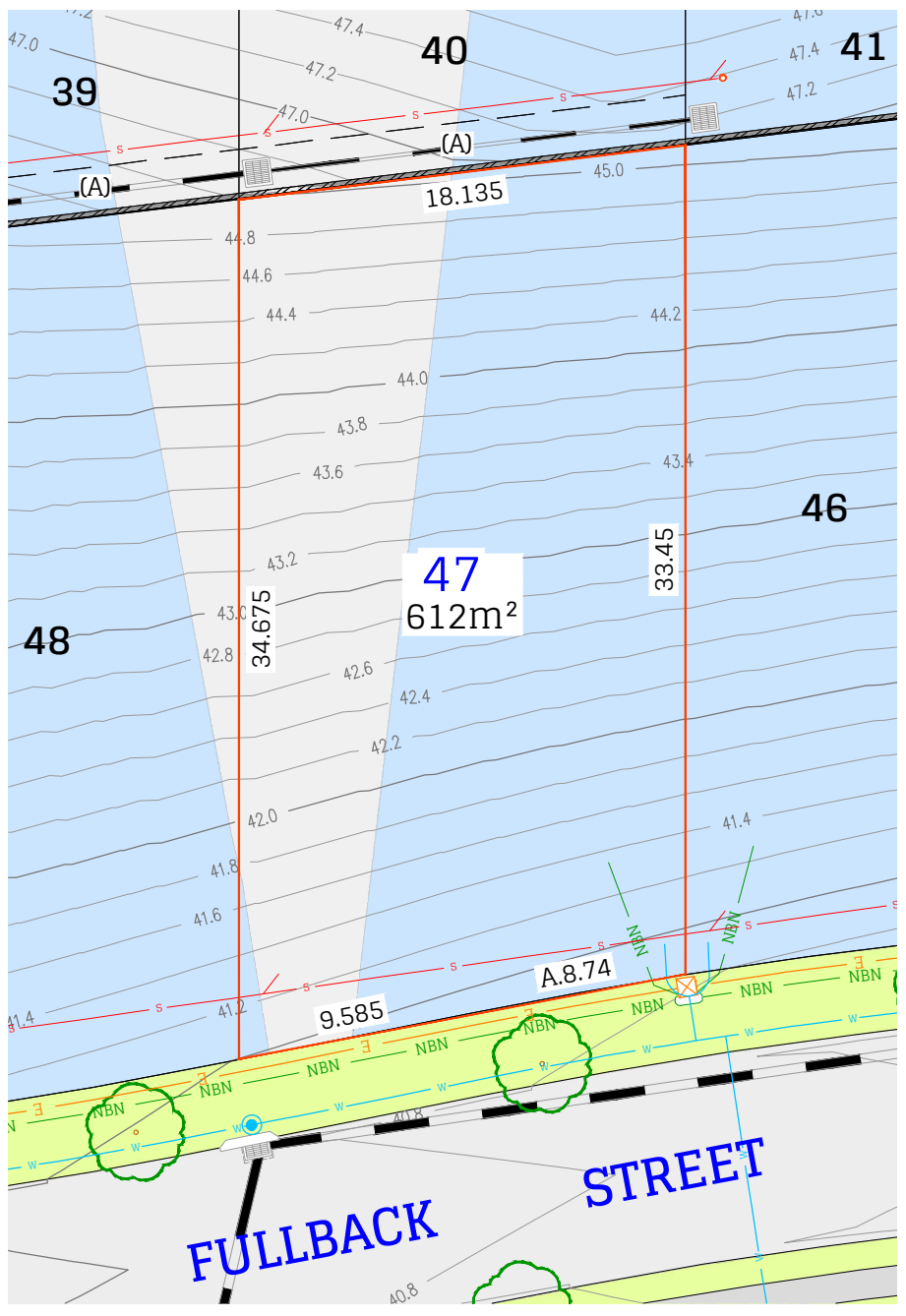

LEGEND:

- Sewer main
- Sewer Man Hole /maintenance shaft
- Water main
- Water Hydrant
- Water Stop Valve
- Stormwater pipe
- Stormwater lintel
- Stormwater Pit
- U/G Electricity services
- Street Light
- Electrical Pillar
- NBN
- NBN Pit
- Retaining Wall
- Design surface contour
- Street Tree

(A) EASEMENT TO DRAIN WATER 2 WIDE

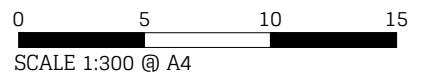

DISCLAIMER/NOTES:

1. Contours are based on finished design levels and are subject to construction and Council certification and therefore should not be considered as final or as-built.
2. Location of utility services including but not limited to power, water, sewer, communications and are subject to construction and Supply Authority certification and therefore should not be considered as final or as-built.
3. Survey information such as boundary dimensions and areas, easements etc are subject to final survey. Purchasers should refer to the Deposited Plan and 888 Instrument contained in the Contract for Sale of Land for further detailed information.
4. This Preliminary Lot Disclosure Plan has been collated from various sources of design information and is provided for convenience to assist Purchasers in obtaining quotation/tenders for dwelling construction.
5. This document does not form part of the Contract of Sale of the Land.

REVISION/S: (C)
DATE: 18/03/2026
BY: ADW Johnson 240268 (2)



Sugarwood

LOT DISCLOSURE PLAN

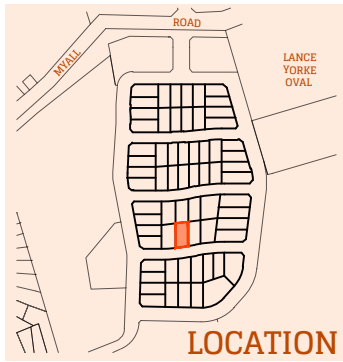

BUSHFIRE ATTACK LEVEL

APZ
BAL 29
BAL 19
BAL 12.5
BAL LOW

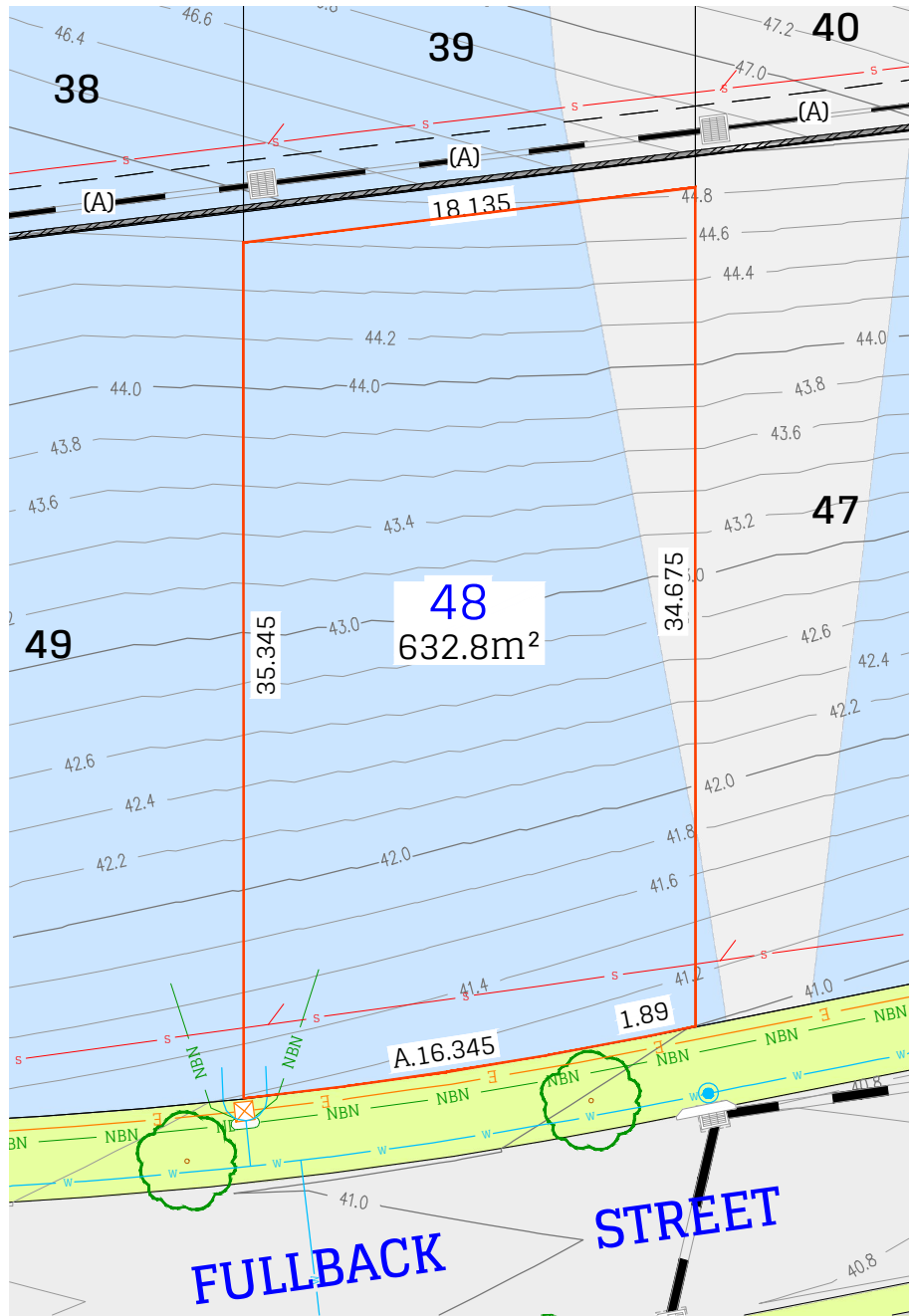

LEGEND:

- Sewer main
- Sewer Man Hole /maintenance shaft
- Water main
- Water Hydrant
- Water Stop Valve
- Stormwater pipe
- Stormwater lintel
- Stormwater Pit
- U/G Electricity services
- Street Light
- Electrical Pillar
- NBN
- NBN Pit
- Retaining Wall
- Design surface contour
- Street Tree

(A) EASEMENT TO DRAIN WATER 2 WIDE

DISCLAIMER/NOTES:

- Contours are based on finished design levels and are subject to construction and Council certification and therefore should not be considered as final or as-built.
- Location of utility services including but not limited to power, water, sewer, communications and are subject to construction and Supply Authority certification and therefore should not be considered as final or as-built.
- Survey information such as boundary dimensions and areas, easements etc are subject to final survey. Purchasers should refer to the Deposited Plan and 888 Instrument contained in the Contract for Sale of Land for further detailed information.
- This Preliminary Lot Disclosure Plan has been collated from various sources of design information and is provided for convenience to assist Purchasers in obtaining quotation/tenders for dwelling construction.
- This document does not form part of the Contract of Sale of the Land.

0 5 10 15

SCALE 1:300 @ A4

REVISION/S: (C)

DATE: 18/03/2026

BY: ADW Johnson 240268 (2)



Sugarwood

LOT DISCLOSURE PLAN

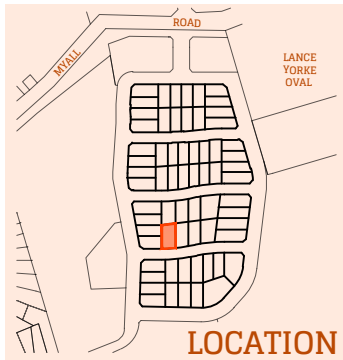

BUSHFIRE ATTACK LEVEL

- APZ
- BAL 29
- BAL 19
- BAL 12.5
- BAL LOW

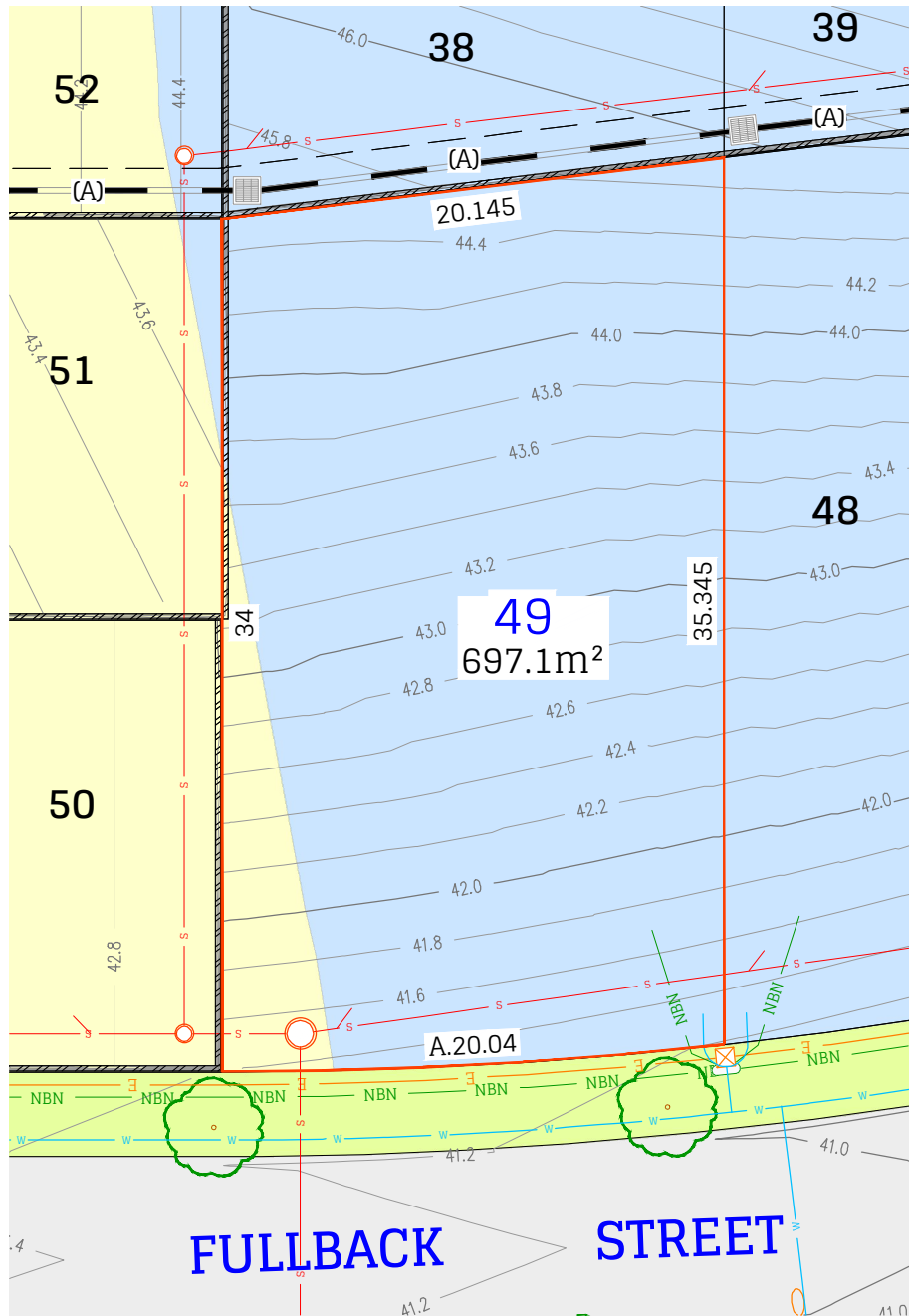

LEGEND:

- Sewer main
- Sewer Man Hole /maintenance shaft
- Water main
- Water Hydrant
- Water Stop Valve
- Stormwater pipe
- Stormwater lintel
- Stormwater Pit
- U/G Electricity services
- Street Light
- Electrical Pillar
- NBN
- NBN Pit
- Retaining Wall
- Design surface contour
- Street Tree

(A) EASEMENT TO DRAIN WATER 2 WIDE

DISCLAIMER/NOTES:

1. Contours are based on finished design levels and are subject to construction and Council certification and therefore should not be considered as final or as-built.
2. Location of utility services including but not limited to power, water, sewer, communications and are subject to construction and Supply Authority certification and therefore should not be considered as final or as-built.
3. Survey information such as boundary dimensions and areas, easements etc are subject to final survey. Purchasers should refer to the Deposited Plan and 88B Instrument contained in the Contract for Sale of Land for further detailed information.
4. This Preliminary Lot Disclosure Plan has been collated from various sources of design information and is provided for convenience to assist Purchasers in obtaining quotation/tenders for dwelling construction.
5. This document does not form part of the Contract of Sale of the Land.

0 5 10 15

SCALE 1:300 @ A4

REVISION/S: (C)

DATE: 18/03/2026

BY: ADW Johnson 240268 (2)



Sugarwood

LOT DISCLOSURE PLAN



BUSHFIRE ATTACK LEVEL

- APZ
- BAL 29
- BAL 19
- BAL 12.5
- BAL LOW

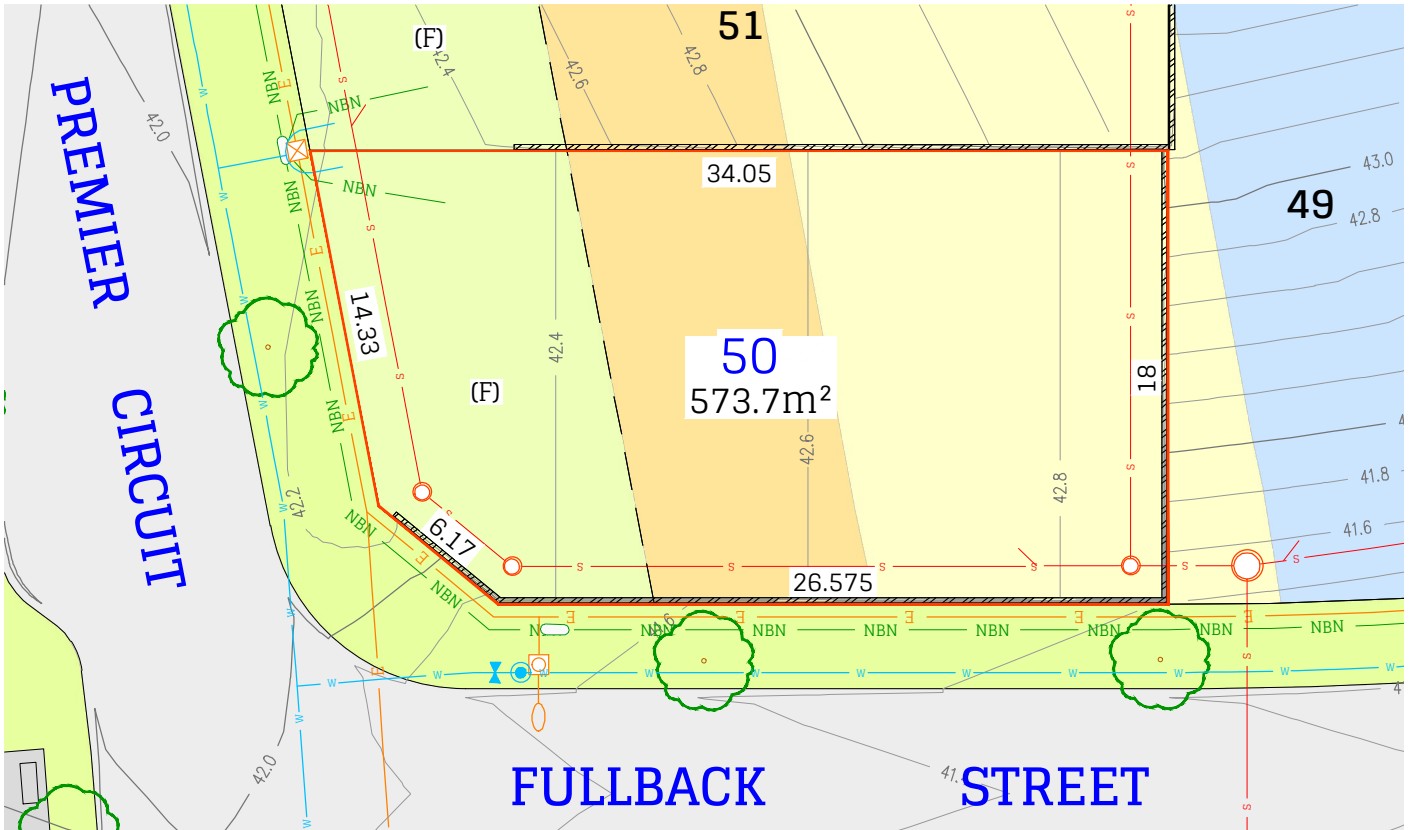

LEGEND:

- Sewer main
- Sewer Man Hole /maintenance shaft
- Water main
- Water Hydrant
- Water Stop Valve
- Stormwater pipe
- Stormwater lintel
- Stormwater Pit
- U/G Electricity services
- Street Light
- Electrical Pillar
- NBN
- NBN Pit
- Retaining Wall
- Design surface contour
- Street Tree

(F) RESTRICTION ON THE USE OF LAND

DISCLAIMER/NOTES:

1. Contours are based on finished design levels and are subject to construction and Council certification and therefore should not be considered as final or as-built.
2. Location of utility services including but not limited to power, water, sewer, communications and are subject to construction and Supply Authority certification and therefore should not be considered as final or as-built.
3. Survey information such as boundary dimensions and areas, easements etc are subject to final survey. Purchasers should refer to the Deposited Plan and 888 Instrument contained in the Contract for Sale of Land for further detailed information.
4. This Preliminary Lot Disclosure Plan has been collated from various sources of design information and is provided for convenience to assist Purchasers in obtaining quotation/tenders for dwelling construction.
5. This document does not form part of the Contract of Sale of the Land.

0 5 10 15

SCALE 1:300 @ A4

REVISION/S: (C)

DATE: 18/03/2026

BY: ADW Johnson 240268 (2)



Sugarwood

LOT DISCLOSURE PLAN

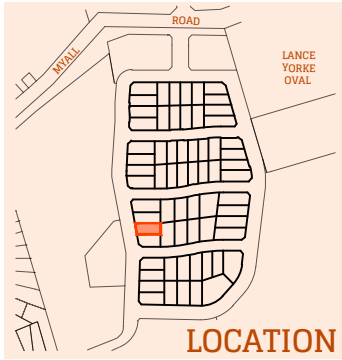

BUSHFIRE ATTACK LEVEL

- APZ
- BAL 29
- BAL 19
- BAL 12.5
- BAL LOW

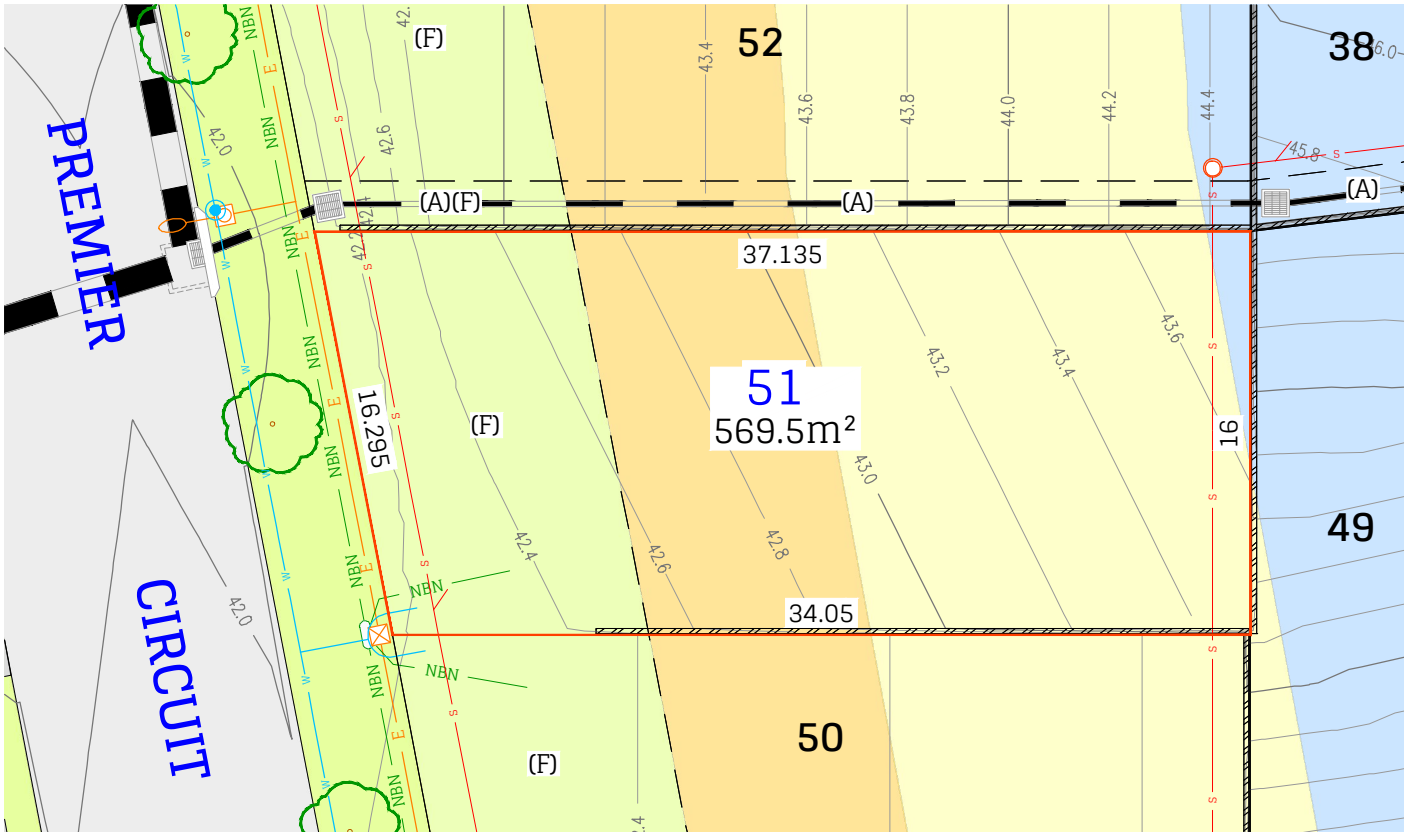

LEGEND:

- Sewer main
- Sewer Man Hole /maintenance shaft
- Water main
- Water Hydrant
- Water Stop Valve
- Stormwater pipe
- Stormwater lintel
- Stormwater Pit
- U/G Electricity services
- Street Light
- Electrical Pillar
- NBN
- NBN Pit
- Retaining Wall
- Design surface contour
- Street Tree

- (A) EASEMENT TO DRAIN WATER 2 WIDE
- (F) RESTRICTION ON THE USE OF LAND

DISCLAIMER/NOTES:

1. Contours are based on finished design levels and are subject to construction and Council certification and therefore should not be considered as final or as-built.
2. Location of utility services including but not limited to power, water, sewer, communications and are subject to construction and Supply Authority certification and therefore should not be considered as final or as-built.
3. Survey information such as boundary dimensions and areas, easements etc are subject to final survey. Purchasers should refer to the Deposited Plan and 888 Instrument contained in the Contract for Sale of Land for further detailed information.
4. This Preliminary Lot Disclosure Plan has been collated from various sources of design information and is provided for convenience to assist Purchasers in obtaining quotation/tenders for dwelling construction.
5. This document does not form part of the Contract of Sale of the Land.



SCALE 1:300 @ A4

REVISION/S: (C)

DATE: 18/03/2026

BY: ADW Johnson 240268 (2)



LOT DISCLOSURE PLAN

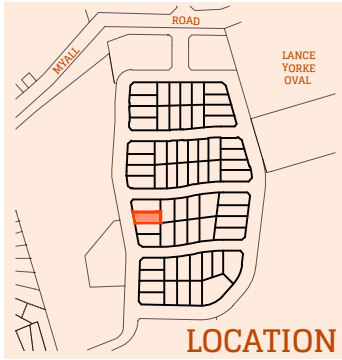

BUSHFIRE ATTACK LEVEL

- APZ
- BAL 29
- BAL 19
- BAL 12.5
- BAL LOW

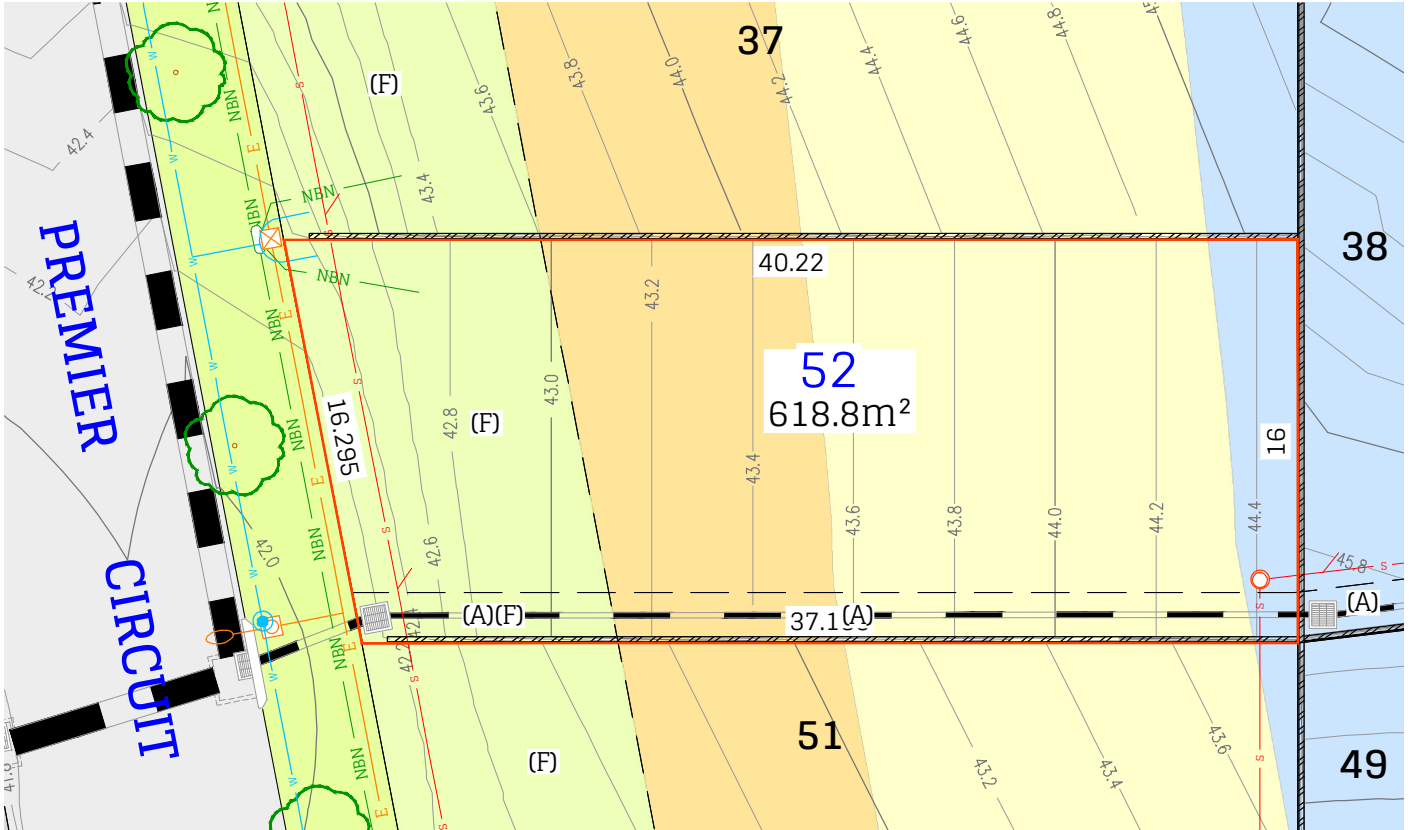

LEGEND:

- s - Sewer main
- Sewer Man Hole /maintenance shaft
- w - Water main
- Water Hydrant
- ⊕ Water Stop Valve
- Stormwater pipe
- Stormwater lintel
- Stormwater Pit
- E - U/G Electricity services
- Street Light
- ⊠ Electrical Pillar
- NBN - NBN
- NBN Pit
- Retaining Wall
- Design surface contour
- Street Tree

- (A) EASEMENT TO DRAIN WATER 2 WIDE
- (F) RESTRICTION ON THE USE OF LAND

DISCLAIMER/NOTES:

1. Contours are based on finished design levels and are subject to construction and Council certification and therefore should not be considered as final or as-built.
2. Location of utility services including but not limited to power, water, sewer, communications and are subject to construction and Supply Authority certification and therefore should not be considered as final or as-built.
3. Survey information such as boundary dimensions and areas, easements etc are subject to final survey. Purchasers should refer to the Deposited Plan and 888 Instrument contained in the Contract for Sale of Land for further detailed information.
4. This Preliminary Lot Disclosure Plan has been collated from various sources of design information and is provided for convenience to assist Purchasers in obtaining quotation/tenders for dwelling construction.
5. This document does not form part of the Contract of Sale of the Land.

0 5 10 15

SCALE 1:300 @ A4

REVISION/S: (C)

DATE: 18/03/2026

BY: ADW Johnson 240268 (2)



Sugarwood